

Digibend
Horizontal
hydraulic bending
machines

EUROMAC®

Horizontal hydraulic bending machines



digibend 200 CNC 200e



| code | description |
|---------|--|
| B#L7D | Digibend 200e (NOT predisposed for CNC backgauge) |
| B#L9D | CNC Digibend 200 (predisposed for CNC backgauge) |
| B#L3D | CNC Digibend 200 with automatic backgauge L. 1250 |
| B#L2D | CNC Digibend 200 with automatic backgauge L. 2000 |
| 9040944 | Hydraulic oil |
| | Touch screen with graphic control DIGIsoft (Only on machine c/w backgauge) |
| | Wooden cage packing (if needed) |
| | Wooden case packing for Digibend c/w CNC L.2000 (if needed) |

Tools recommended for bending bars

| code | description |
|----------|--|
| Z#BMT195 | Die holder extension L. 45 mm - H. 190 mm |
| Z#BPT041 | Pin predisposed for insert Ø 80 mm - H. 200 mm (multifunction) |
| Z#BPT042 | Pin bending punch Ø 80 mm - H. 200 mm - 86° - R.5 |
| KAP-433 | Kit antiflextion bar for single bending punch H.200 mm |

The pin predisposed for insert (multifunction) Ø 80 mm H=200 mm (Z#BPT041) can be used to fix the 2/4 jaw pipe bending tool, straightening tool and the movable bending punch.

All the pin bending punches and the multifunction insert punch holder, used individually, can work along with the antiflextion bar in order to make high thickness boxes. Bending inserts and dies at your choice (pages 6-7).

standard equipment

- Remote foot pedal switch
- Manual backgauge L. 600 mm
- Set of keys
- Instruction manual
- Memory card SD - 4Gb (Not on Digibend 200e)

general selling conditions

- Price Ex works Euromac Italy
- Packing on pallet with polyethylene cover
- Tooling and hydraulic oil **not included**

Horizontal hydraulic bending machines



digibend 400 CNC



| code | description |
|---------|--|
| B#M9D | CNC Digibend 400 (predisposed for CNC backgauge) |
| B#M3D | CNC Digibend 400 with automatic backgauge L. 1250 |
| B#M2D | CCNC Digibend 400 with automatic backgauge L. 2000 |
| | Touch screen with graphic control DIGIsoft (Only on machine c/w backgauge) |
| 9040944 | Hydraulic oil |
| | Wooden cage packing (if needed) |
| | Wooden case packing for Digibend c/w CNC L.2000 (if needed) |

Tools recommended for bending bars

| code | description |
|-------------------|--|
| Z#BMT201 | Die holder extension L. 85 mm - H. 190 mm |
| Z#BPT041 | Pin predisposed for insert Ø 80 mm - H. 200 mm (multifunction) |
| Z#BPT042 | Pin bending punch Ø 80 mm - H. 200 mm - 86° - R.5 |
| KAP-381 | Kit antiflection bar for single bending punch H.200 mm |
| KAP-381 + KAP-383 | Kit antiflection bar complete with holder for single bending punch H.350 mm (page 7) |

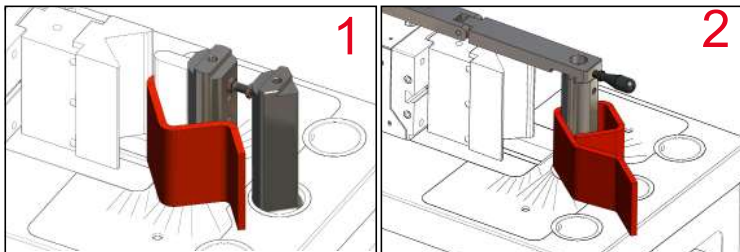

- 1) The **pin predisposed for insert (multifunction) Ø 80 mm - H. 200 mm (Z#BPT041)** together with **pin bending punch Ø 80 mm H. 200 mm -86° - R.5 (Z#BPT042)**, assembled one in front of the other, become one single part for **high thickness bending**.
- 2) All the pin bending punches and the multifunction insert punch holder, used individually, can work along with the antiflection bar in order to make high thickness boxes. The **pin predisposed for insert (multifunction) Ø 80 mm - H. 200 mm (Z#BPT041)** can be used to fix the 2/4 jaw pipe bending tool, the straightening tool, the punching unit, the shearing tool and the movable bending punch.

standard equipment

- Remote foot pedal switch
- Manual backgauge L. 600 mm
- Set of keys
- Instruction manual
- Memory card SD - 4Gb

general selling conditions

- Price Ex works Euromac Italy
- Packing on pallet with polyethylene cover
- Tooling and hydraulic oil **not included**

Horizontal hydraulic bending machines

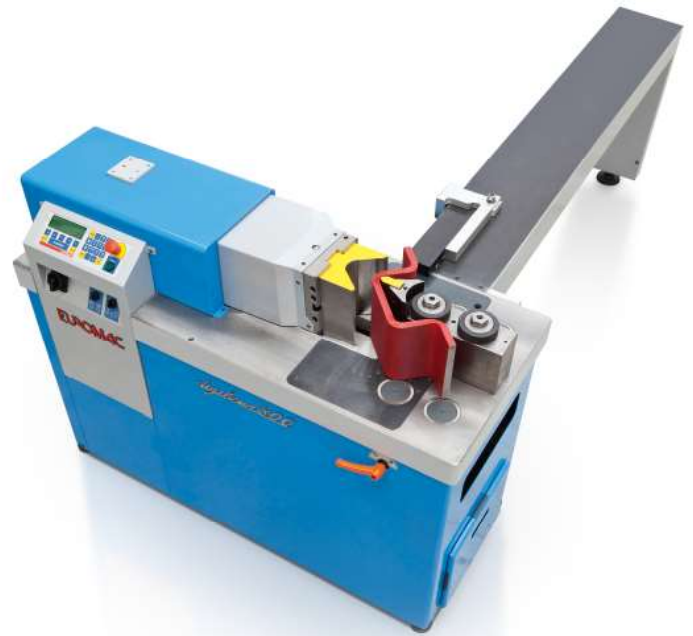

digibend 800 CNC

| code | description |
|---------|--|
| B#N9D | CNC Digibend 800 (predisposed for CNC backgauge) |
| B#N3D | CNC Digibend 800 with automatic backgauge L. 1250 |
| B#N2D | CNC Digibend 800 with automatic backgauge L. 2000 |
| | Touch screen with graphic control DIGIsoft (Only on machine c/w backgauge) |
| 9040944 | Hydraulic oil |
| | Wooden cage packing (if needed) |
| | Wooden case packing for Digibend c/w CNC L.2000 (if needed) |

Tools recommended for bending bars

| code | description |
|-------------------|---|
| Z#BMT201 | Die holder extension L. 85 mm - H. 190 mm |
| TB#72BE-01 | Two-hole bending punch H. 200 mm c/w 3 inserts (R. 3 - 6 -10) |
| KAP-382 | Kit antiflection bar for single bending punch H.200 mm |
| KAP-382 + KAP-384 | Kit antiflection bar complete with holder for bending punch H.350 mm (page 7) |

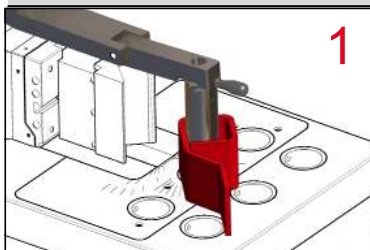

1) All the pin bending punches and the pin predisposed for insert (multifunction) used individually, can work along with the antiflection bar in order to make high thickness boxes.

The **pin predisposed for insert (multifunction) Ø 80 mm - H. 200 mm (Z#BPT041)** can be used to fix the 2/4 jaw pipe bending tool, the straightening tool, the punching unit, the shearing tool and the movable bending punch.

standard equipment

- 2 quick change tooling locator pins Ø 80 mm H.200
- Remote foot pedal switch
- Manual backgauge L. 600 mm
- Set of keys
- Instruction manual
- Memory card SD - 4Gb

general selling conditions

- Price Ex works Euromac Italy
- Packing on pallet with polyethylene cover
- Tooling and hydraulic oil **not included**

optionals Digibend 200 - 400 - 800

Bending Punches

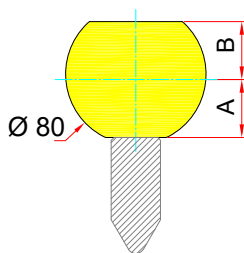
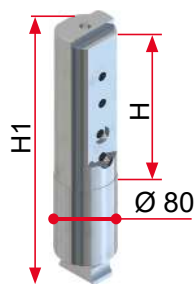

Insert punch holder Ø80

| H | H1 | A | B | code |
|-----|-----|----|----|----------|
| 200 | 384 | 37 | 30 | Z#BPT041 |
| 350 | 520 | 37 | 30 | Z#BPT039 |

Pin predisposed for inserts (multifunction)

It can be used to fix the 2/4 jaw bending tool, the straightening tool, the punching unit, the shearing tool and the movable bending punch.

Coupable Punch

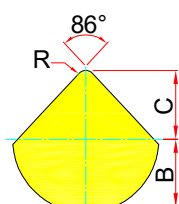
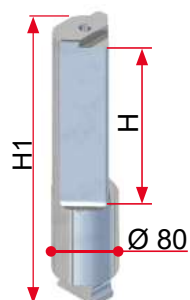

Pin bending punch Ø80

| H | H1 | A | B | C | R | code |
|-----|-----|-----|----|----|---|----------|
| 200 | 384 | 86° | 37 | 37 | 5 | Z#BPT042 |
| 350 | 520 | 86° | 37 | 37 | 5 | Z#BPT040 |

Coupable Punch

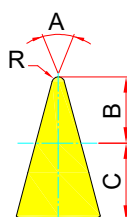
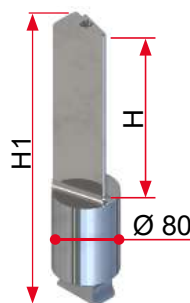

Pin bending punch Ø80 L.80 mm - 30° - R.3 - H.200mm

| H | H1 | A | B | C | R | code |
|-----|-----|-----|----|----|---|----------|
| 200 | 384 | 30° | 31 | 37 | 3 | Z#BPT043 |

To be used to bend up to 30°

To be used with "U" dies

Coupable Punch

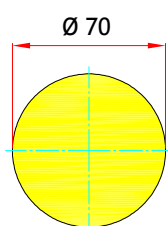
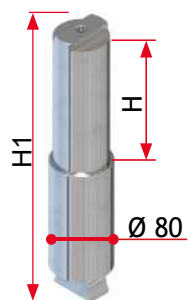

Shape holder central pin Ø80 H.200

| H | H1 | code |
|-----|-----|----------|
| 200 | 384 | Z#BPT046 |

Pin arranged for special shapers.

Can be used to bend flat, round and tubular bars up to 180°.

Special shapers not listed in the price list.

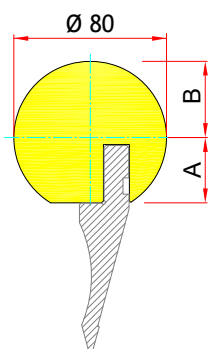
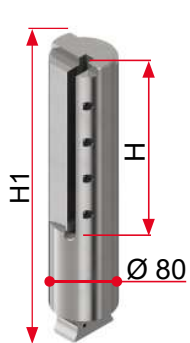

Promecam insert punch holder Ø80

| H | H1 | A | B | codice |
|-----|-----|------|----|----------|
| 200 | 384 | 32.4 | 40 | Z#BPT047 |
| 350 | 520 | 32.4 | 40 | Z#BPT048 |

Pin predisposed for Promecam inserts.

optionals DIGIBEND 200 - 400 - 800

Bending Punches

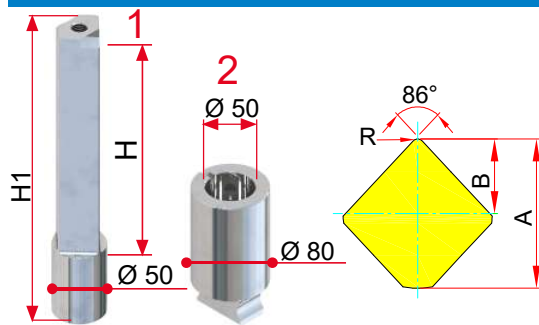

Pin bending punch L.50 and punch adapter

| Mod | H1 | H | A | B | R | code |
|-----|---------|-----|----|----|---|----------|
| 1 | 307 | 200 | 50 | 25 | 2 | Z#BPT044 |
| 2 | Adapter | | | | | Z#BPT032 |

Recommended the antiflection bar.

Purchasing the punch 1 it is necessary to buy the adapter 2

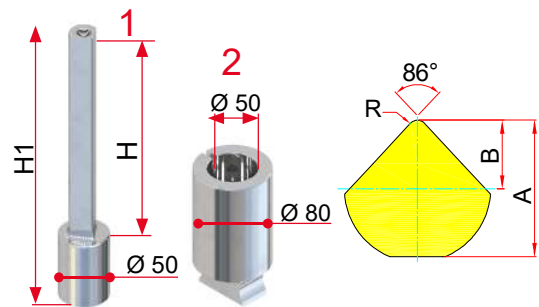

Pin bending punch L.30 and punch adapter

| Mod | H1 | H | A | B | R | code |
|-----|---------|-----|----|----|---|----------|
| 1 | 307 | 200 | 28 | 15 | 2 | Z#BPT045 |
| 2 | Adapter | | | | | Z#BPT032 |

Strongly recommended the antiflection bar

Purchasing the punch 1 it is necessary to buy the adapter 2

Bending inserts

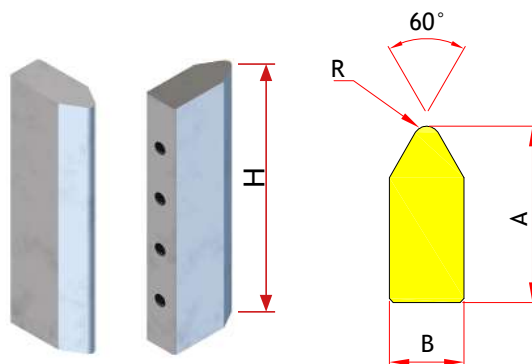

| H | R | A | B | | code |
|-----|-----|----|----|----------|----------|
| 200 | 1,5 | 66 | 28 | standard | Z#BMT188 |
| 200 | 5 | 66 | 28 | standard | Z#BMT190 |
| 200 | 10 | 66 | 28 | standard | Z#BMT193 |
| 200 | 3 | 66 | 28 | special | Z#BMT189 |
| 200 | 6 | 66 | 28 | special | Z#BMT191 |
| 200 | 8 | 66 | 28 | special | Z#BMT192 |
| 200 | 12 | 66 | 28 | special | Z#BMT194 |
| 200 | 15 | 66 | 28 | special | Z#BMT251 |
| 350 | 1,5 | 66 | 28 | special | Z#BMT247 |
| 350 | 5 | 66 | 28 | special | Z#BMT248 |
| 350 | 10 | 66 | 28 | special | Z#BMT249 |

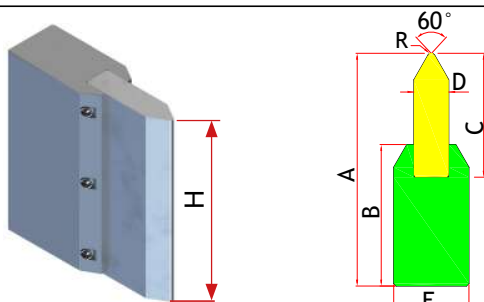

Movable bending punch c/w n°1 insert R.3

| H | R | A | B | C | D | E | code |
|---------------|---|-----|-----|----|----|----|------------|
| 200 | 3 | 186 | 113 | 99 | 28 | 60 | TB#99MP-02 |
| Single insert | | | | | | | Z#BMT217 |

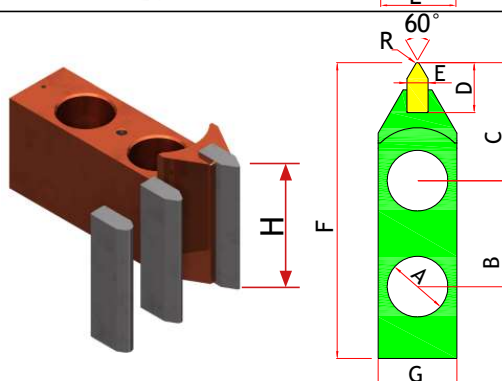

Two-hole-bending punch H. 200 mm c/w 3 inserts (R. 3 - 6 - 10) for DIGIBEND 800

| H | R | A | B | C | D | E | F | G | code |
|-----|--------|----|-----|-----|----|----|-----|-----|------------|
| 200 | 3-6-10 | 80 | 140 | 156 | 66 | 28 | 390 | 104 | TB#72BE-01 |

To be fixed with the 2 locator pins supplied along with Digibend 800

Antiflection bars

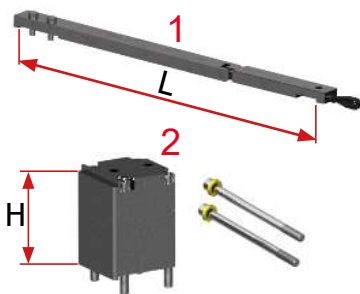

Antiflection bars

| Mod | Digibend | H | L | description | code |
|-----|----------|-----|------|------------------|---------|
| 1 | 200 | | | Antiflection bar | KAP-433 |
| 2 | 400 | | 894 | Antiflection bar | KAP-381 |
| 1 | 400 | 139 | | Pins H.350 Shim | KAP-383 |
| 2 | 800 | | 1090 | Antiflection bar | KAP-382 |
| 2 | 800 | 104 | | Pins H.350 Shim | KAP-384 |

Die Holder Extension

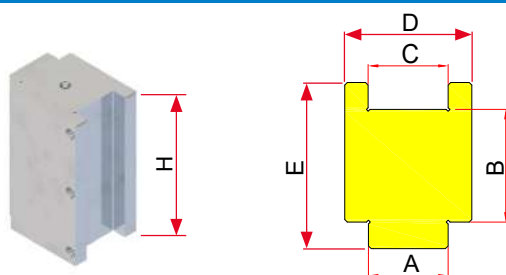

Die holder extension

| H | A | B | C | D | E | code |
|-----|----|----|----|----|-------|----------|
| 190 | 60 | 45 | 60 | 96 | 85.5 | Z#BMT195 |
| 190 | 60 | 85 | 60 | 96 | 125.5 | Z#BMT201 |
| 350 | 60 | 85 | 60 | 96 | 125.5 | Z#BMT265 |

Single "V" Dies

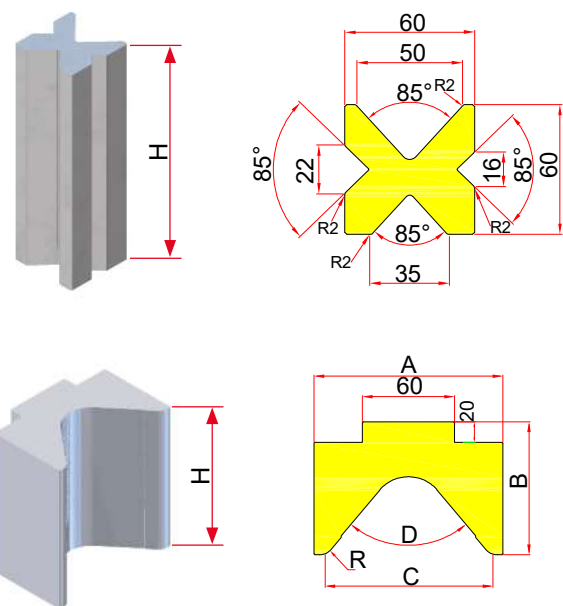

Single "V" Dies

| Mod | H | A | B | C | D | R | code |
|-------|-----|-----|-----|-----|-----|----|----------|
| 4 V | 200 | | | | | | Z#BDT007 |
| V 63 | 200 | 80 | 75 | 63 | 85° | 5 | Z#BDT008 |
| V 80 | 200 | 95 | 80 | 80 | 85° | 5 | Z#BDT009 |
| V 100 | 200 | 115 | 95 | 100 | 85° | 8 | Z#BDT010 |
| V 125 | 200 | 154 | 103 | 125 | 80° | 15 | Z#BDT011 |
| V 160 | 200 | 185 | 130 | 160 | 80° | 15 | Z#BDT012 |
| 4 V | 350 | | | | | | Z#BDT034 |
| V 63 | 350 | 80 | 75 | 63 | 85° | 5 | Z#BDT035 |
| V 80 | 350 | 95 | 80 | 80 | 85° | 5 | Z#BDT036 |
| V 100 | 350 | 115 | 95 | 100 | 85° | 8 | Z#BDT037 |
| V 125 | 350 | 154 | 103 | 125 | 80° | 15 | Z#BDT038 |
| V 160 | 350 | 185 | 130 | 160 | 80° | 15 | Z#BDT039 |

Single rotary pin dies 88°

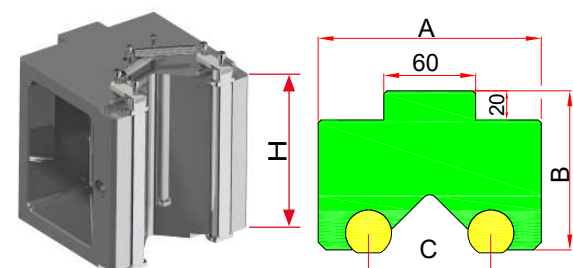

Single rotary pin dies 88°

| Mod | H | A | B | C | code |
|-------|-----|-----|-----|-----|------------|
| V 50 | 200 | 95 | 105 | 50 | TB#99RP-07 |
| V 65 | 200 | 118 | 178 | 65 | TB#99RP-14 |
| V 90 | 200 | 146 | 185 | 90 | TB#99RP-08 |
| V 125 | 200 | 198 | 203 | 125 | TB#99RP-09 |

optionals Digibend 200 - 400 - 800

Single "U" Dies for bends up to 30°

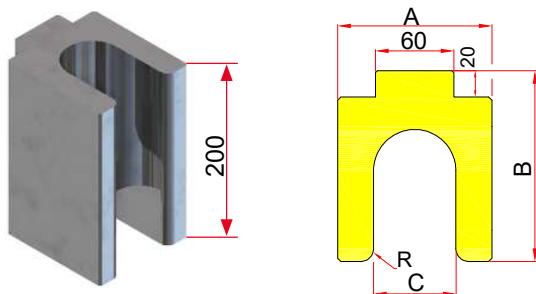

Single "U" Dies

| Mod | A | B | C | R | code |
|------|-----|-----|----|----|----------|
| U 50 | 118 | 95 | 50 | 10 | Z#BDT016 |
| U 63 | 118 | 146 | 63 | 10 | Z#BDT017 |
| U 80 | 148 | 196 | 80 | 10 | Z#BDT018 |

Tooling

Shearing tool for steel and copper

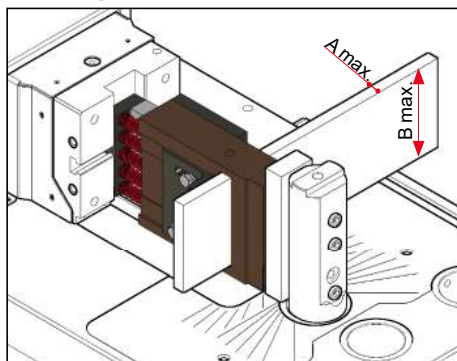

| A max. | B max. | code |
|--------|--------|------------|
| 13 mm | 150 mm | TB#99SH-08 |
| 12 mm | 200 mm | TB#99SH-07 |

Shearing tool c/w bar stop H. 150 mm and 200 mm with automatic blade adjustment Max. thickness 13 mm c/w blades for copper and steel

Necessary to buy also:

Insert punch holder Z#BPT041.

If it is used material over 10 mm thickness is recommended to use a second pin bending punch (Z#BPT042).

Punching unit

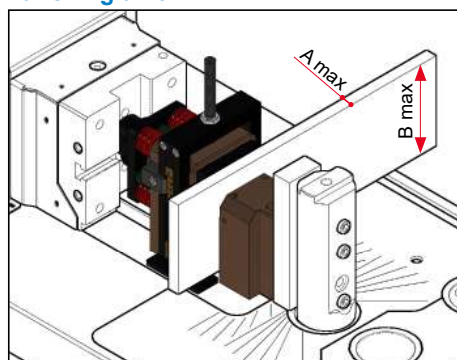

| A max. | B max. | code |
|--------|--------|------------|
| 12 mm | 200 mm | TB#99PU-02 |

Punching unit for flat bars c/w extractor and adjustable bar holder H. 100 mm. Max. Ø 30 mm.

For punches Geka type

Punch type: Series 8/31 - Die type: Series 5/27

(not included with the tool)

Necessary to buy also:

Insert punch holder Z#BPT041

If it is used material over 10 mm thickness is recommended to use a second pin bending punch (Z#BPT042)

This tool can not be used on Digibend 200.

Two jaw pipe bending tool

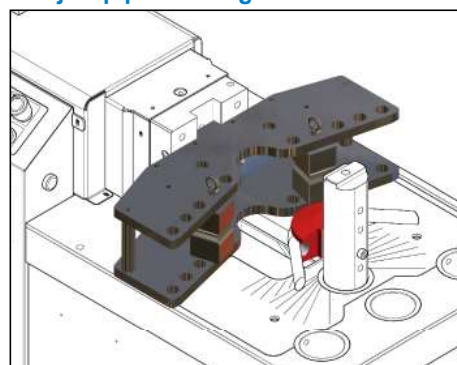

| code |
|------------|
| TB#99J2-04 |

Two jaw pipe bending tool for thick pipes Ø max. 60 mm.

c/w movable part with two jaws

Max. bending angle: 90°

Necessary to buy also:

Insert punch holder Z#BPT041

If it is used material over 10 mm thickness is recommended to use a second pin bending punch (Z#BPT042) (shapers not included)

Trasformation Kit
from 2 to 4 Jaw tool

KAP-367

Four jaw pipe bending tool

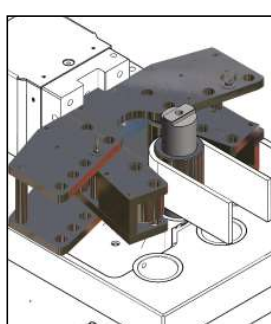
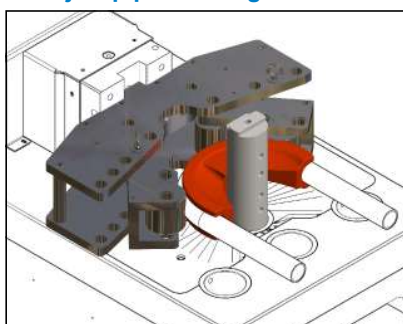

| code |
|------------|
| TB#99J4-04 |

Four jaw pipe bending tool for thick pipes Ø max. 48.3 mm -

flat bars c/w movable part with four jaws

Max. bending angle: 180°

Necessary to buy also:

Insert punch holder Z#BPT041 or Z#BPT046

If it is used material over 10 mm thickness is recommended to use a second pin bending punch (Z#BPT042) (shapers not included)

optionals Digibend 200 - 400 - 800

Tooling

Shapers for 2- 4 jaw-bending pipe tool

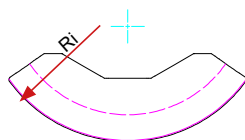
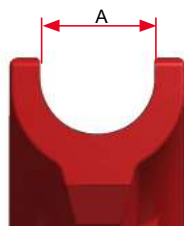

| Mod | A | Ri | Mod.Digibend | code |
|-------------|------|------|--------------|----------|
| Ø 3/8"Gas | 17.2 | 36.5 | 200-400-800 | Z#BMT005 |
| Ø 1/2"Gas | 21.3 | 40 | 200-400-800 | Z#BMT006 |
| Ø 3/4"Gas | 26.9 | 52 | 200-400-800 | Z#BFT001 |
| Ø 1"Gas | 33.7 | 80 | 200-400-800 | Z#BFT002 |
| Ø 1 1/4"Gas | 42.4 | 110 | 400-800 | Z#BFT003 |
| Ø 1 1/2"Gas | 48.3 | 128 | 400-800 | Z#BFT004 |
| Ø 2"Gas | 60.3 | 180 | 400-800 | Z#BFT005 |

Straightening tool

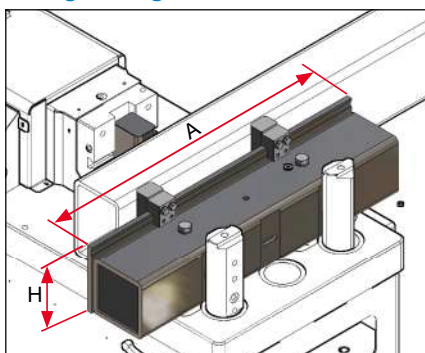

| A | H | note | code |
|------|-----|---------------|------------|
| 800 | 200 | Digibend 200 | TB#20BS-01 |
| 800 | 200 | Digibend 400* | TB#40BS-01 |
| 1200 | 200 | Digibend 800 | TB#72BS-01 |

Straightening tool H.200 c/w bending punh

* *ONLY FOR DIGIBEND 400: It is necessary to order also Z#BPT041 e Z#BPT042*

Set of two flanges

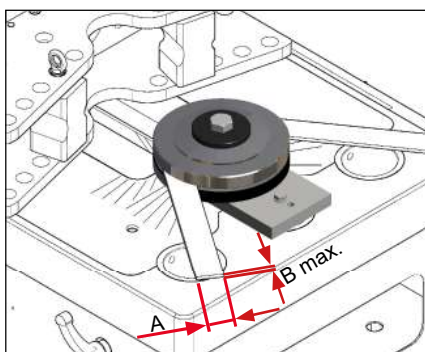

| A | A max. | B max. | code |
|----|--------|--------|------------|
| 30 | 60 | 23 | TB#99BB-03 |

Set of 2 flanges for flat bending c/w 4 inserts, thickness 4-5-6-8 mm.

Ri 50 mm.
c/w flange holder pin

Necessary to have also the 2 jaw bedning tool TB#99J2-04 not included

Rotary bending tool

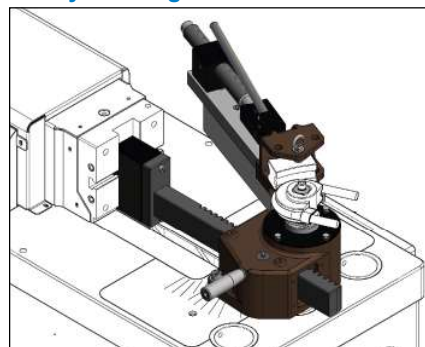

| code |
|------------|
| TB#99RT-02 |

Rotary bending tool for tubes Ø max. 42,4 mm.

Max. bending angle: 180°

Rapid pipe clamping
(shapers not included)

Shaper and countershapers for Rotary bending tool

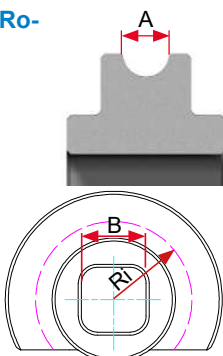
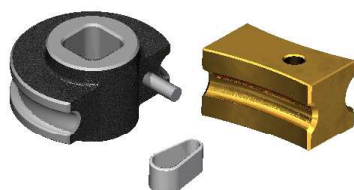

| Mod | A | Ri | B | code |
|-------------|------|------|------|----------|
| Ø 3/8"Gas | 17.2 | 53.5 | 32 | Z#BFT012 |
| Ø 1/2"Gas | 21.3 | 59 | 32 | Z#BFT013 |
| Ø 3/4"Gas | 26.9 | 78 | 32 | Z#BFT014 |
| Ø 1" Gas | 33.7 | 100 | 42.5 | Z#BFT015 |
| Ø 1 1/4"Gas | 42.4 | 157 | 42.5 | Z#BFT016 |

optionals Digibend 200 - 400 - 800

Tooling

Backgauge

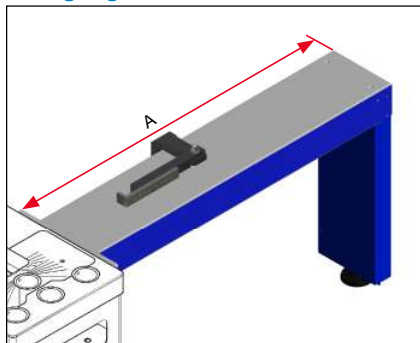

| A min. | code |
|--------|-------------|
| 1250 | KMB#F3D0-02 |
| 2000 | KMB#F2D0-02 |
| 3000 | KMB#F4D0-01 |

digibend 200 CNC

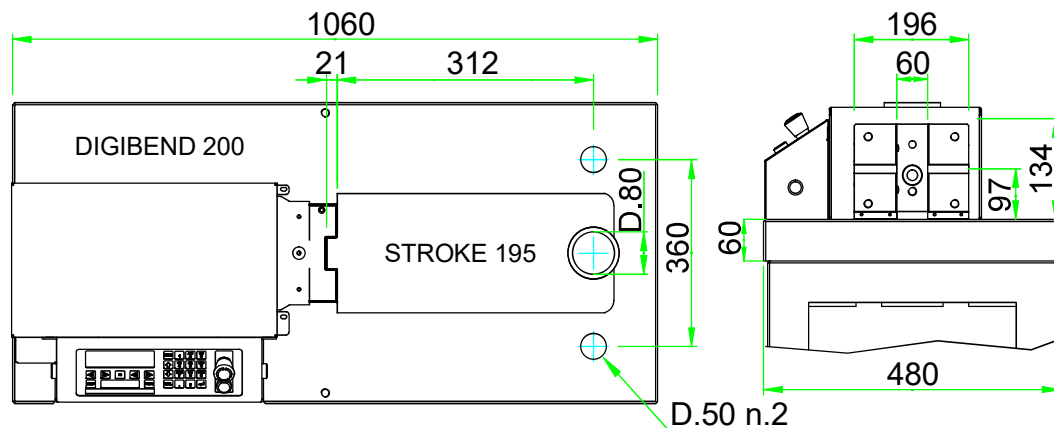

- The **monoblock frame** in a unique strong nodular cast iron (Meehanite 600 N/mm²) has been computer assisted designed according to the finite element method. The monoblock frame incorporates the working cylinder to ensure the maximum rigidity during the press operation.
- **2 tool clamping systems on the wide working table**
 - a) 1 central hole Ø 80 for rapid clamping
 - b) 2 side holes Ø 50 interaxis 360 mm
- Max. tool high: 200 mm.
- Electronic stroke adjustment with digital readout, by means of a transducer for max. precision of $\pm 0,10$ mm.
- All working parts are **hardened and grounded**.
- **Digibend** is at the same time **flat bars and tube bending, press, shearing, punching and straightening machine**.
- The **CNC backgauge** is programmable from the main board.
- **Automatic programmable piece release**.
- **Automatic slow down** in bending, programmable from 10 to 195 mm. stroke. (not on Digibend 200e)
- **High precision** ($\pm 0,10$ mm) for a sequence bending.
- **Easy programming** with working parameters in required language: Chinese, Czech, German, Greek, English, Spanish, Persian, Finnish, French, Hungarian, Italian, Korean, Lithuanian, Dutch, Polish, Rumanian, Russian, Slovenian, Thai, Turkish & other languages.
- Electronic stroke adjustment with **digital readout**.
- **Control panel** for programming and memorizing up to **255 working positions**.
- **Readout for bending parameters**
- Possibility to store up to **80 bends** in a working sequence and to memorize up to **55 sequences**
- Selector for 3 working functions: **by single stroke - step by step - automatic**.
- **Bending capacity** for wide thicknesses up to **H.200 x 15 mm** (and beyond).
- **Store and search of programme through** its name and additional information: **die type, punch type, thickness, and desired angle**.
- Pedal with security switch.
- CNC backgauge option available.
- Micro SD card for programme back-up.

digibend 400 CNC

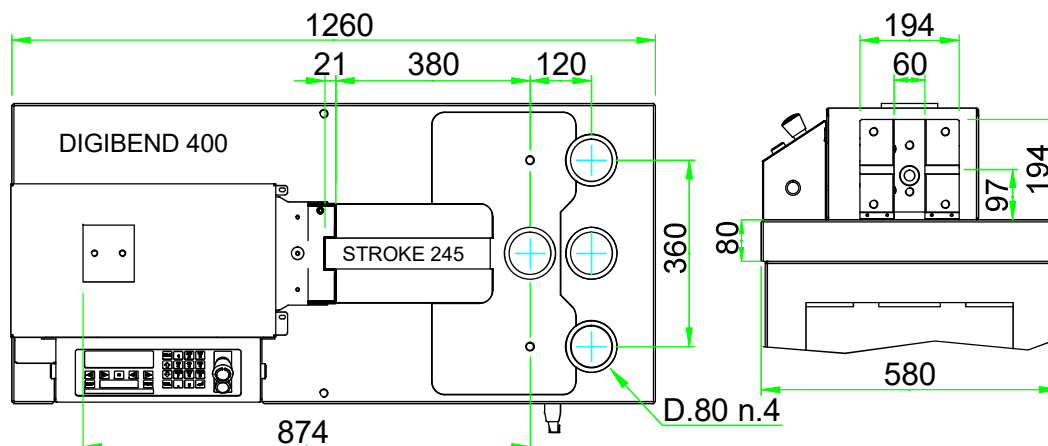

- The **monoblock frame** in a unique strong nodular cast iron (Meehanite 600 N/mm²) has been computer assisted designed according to the finite element method. The monoblock frame incorporates the working cylinder to ensure the maximum rigidity during the press operation.

- **4 tool clamping systems on the wide working table**

- 1 central hole Ø 80 for rapid clamping
- 1 central hole Ø 80 interaxes 120 mm
- 2 aligned side holes Ø 80 interaxes 360 mm

- All working parts are hardened and grounded.

- **Movable head provided with hardened T guides**

- **Control panel** for programming and memorizing up to **255 working positions**.

- **Digibend** is at the same time **flat bars** and **tube bending, press, shearing, punching and straightening machine**.

- **The CNC backgauge** is programmable from the main board.

- **Automatic programmable piece release**.

- **Automatic slow down** in bending, programmable from 10 to 245 mm stroke.

- **High precision** ($\pm 0,10$ mm) for a sequence bending.

- **Easy programming** with working parameters in required language: Chinese, Czech, German, Greek, English, Spanish, Persian, Finnish, French, Hungarian, Italian, Korean, Lithuanian, Dutch, Polish, Rumanian, Russian, Slovenian, Thai, Turkish & other languages.

- Electronic stroke adjustment with **digital readout**.

- **Readout for bending parameters**.

- Possibility to store up to **80 bends** in a working sequence and to memorize up to **55 sequences**

- **Programmable hole step** in punching sequences.

- Selector for 3 working functions: **by single stroke - step by step - automatic**.

- **Bending capacity** for wide thicknesses up to **H.200 x 20 mm** (and beyond).

- Height bending capacity for materials **H. 350 mm**.

- **Store and search of programme** through its name and additional information: **die type, punch type, thickness, and desired angle**.

- Pedal with security switch .

- **Working pressure adjuster from 400 a 200 kN** (in order to prevent damage to small tools or soft materials).

- CNC backgauge option available.

- Micro SD card for programme back-up.

OPTIONAL

Touch screen with graphic control DIGIsoft:

- 12" LCD Touch screen
- USB port and Wi-Fi connection
- 2D graphic visualization
- DXF import files
- Integrated UPS system
- Extremely sensitive (it can even be used with working gloves)
- Step-by-step forward and backward simulation

digibend 800 CNC

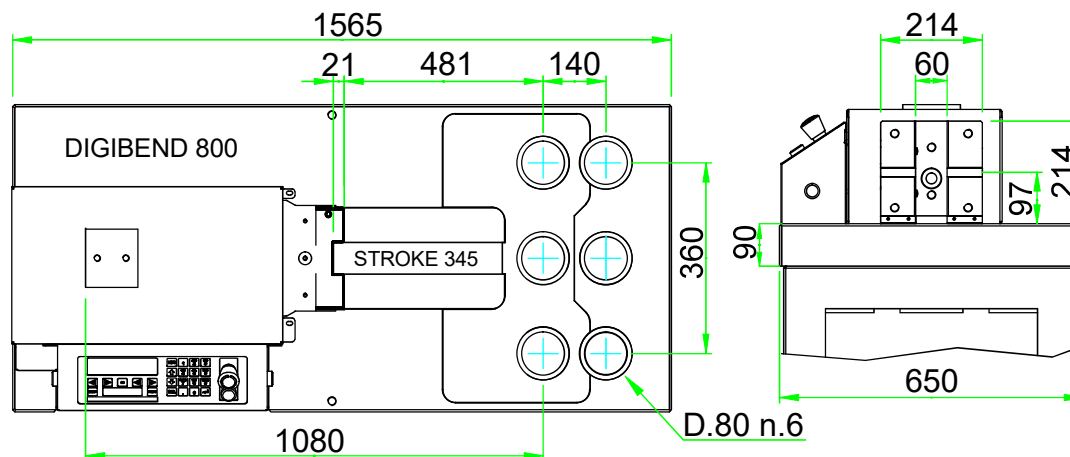

- The **monoblock frame** in a unique strong nodular cast iron (Meehanite 600 N/mm²) has been computer assisted designed according to the finite element method. The monoblock frame incorporates the working cylinder to ensure the maximum rigidity during the press operation.
- **6 tool clamping systems on the wide working table**
 - a) 1 central hole Ø 80 for rapid clamping
 - b) 1 central hole Ø 80 interaxes 140 mm
 - c) 2 aligned side holes Ø 80 interaxes 360 mm
 - d) 2 aligned side holes Ø 80 interaxes 360 mm next to the 2° central hole
- For several tools there is the possibility of a **quick change tool system** with 2 excentric pins Ø 80
- All working parts are hardened and grounded.
- **Movable head provided with hardened T guides**
- **Control panel** for programming and memorizing up to **255 working positions**.
- **Digibend** is at the same time **flat bars and tube bending, press, shearing, punching and straightening machine**.
- **The CNC backgauge** is programmable from the main board.
- **Automatic programmable piece release**.
- **Automatic slow down** in bending, programmable from 10 to 345 mm stroke.
- **High precision** ($\pm 0,10$ mm) for a sequence bending.
- **Easy programming** with working parameters in required language: Chinese, Czech, German, Greek, English, Spanish, Persian, Finnish, French, Hungarian, Italian, Korean, Lithuanian, Dutch, Polish, Rumanian, Russian, Slovenian, Thai, Turkish & other languages.
- Electronic stroke adjustment with **digital readout**.
- **Readout for bending parameters**.
- Possibility to store up to **80 bends** in a working sequence and to memorize up to **55 sequences**.
- **Programmable hole step** in punching sequences.
- Selector for 3 working functions: **by single stroke - step by step - automatic**.
- Height bending capacity for materials **H. 350 mm**.
- **Store and search of programme** through its name and additional information: **die type, punch type, thickness, and desired angle**.
- Pedal with security switch.
- **Working pressure adjuster from 800 a 400 kN** (in order to prevent damage to small tools or soft materials).
- CNC backgauge option available.
- Micro SD card for programme back-up.

OPTIONAL

Touch screen with graphic control DIGIsoft:

- 12" LCD Touch screen
- USB port and Wi-Fi connection
- 2D graphic visualization
- DXF import files
- Integrated UPS system
- Extremely sensitive (it can even be used with working gloves)
- Step-by-step forward and backward simulation

| | 200 CNC | 400 CNC | 800 CNC |
|---|----------------------|------------------------|------------------------|
| Max. pressure (kN) | 200 | 400 | 800 |
| Max. stroke (mm) | 195 | 245 | 345 |
| Max. working speed (mm/sec) | 9.6 | 9.6 | 9.3 |
| Min. working speed (mm/sec) | 4.8 | 4.8 | 4.6 |
| Return speed (mm/sec) | 48 | 62 | 45 |
| Average working speed (mm/sec) | 28.8 | 35.8 | 27.2 |
| Working table dimensions (mm) | 480 x 1060 x 925 (H) | 580 x 1230 x 925 (H) | 650 x 1565 x 925 (H) |
| Fixing holes in working table (nr. x Ø - mm) | 1 x Ø 80 / 2 x Ø 50 | 4 x Ø 80 | 6 x Ø 80 |
| Working height (mm) | 925 | 925 | 925 |
| Oil tank capacity (lt.) | 40 | 40 | 60 |
| Motor HP - Kw | 3 - 2 | 5.5 - 4 | 5.5 - 4 |
| High bending (mm) | H=200 | H=200 | H=200 |
| Extra high bending (mm) | / | H=350 | H=350 |
| Shearing max thickness 40 kg/mm (iron) | / | H=150 x 10 (thickness) | H=150 x 12 (thickness) |
| Punching max thickness 40 kg/mm (iron) | / | Ø 30 x 10 (thickness) | Ø 30 x 12 (thickness) |
| Straightening (H/thickness) | H=200 | H=200 | H=200 |
| Two-jaw-bending (mm) | Ø 33.7 | Ø 60 | Ø 60 |
| Rotary bending (mm) | Ø 33.7 | Ø 42.4 | Ø 42.4 |
| CNC automatic backgauge | 1250 / 2000 | 1250 / 2000 | 1250 / 2000 |
| Approx. weight (kg) | 340 | 700 | 1500 |
| Overall dimensions (L x l x h) | 580 x 1060 x 1150 | 580 x 1230 x 1150 | 750 x 1565 x 1200 |

Note

[illegible]



sheet metal working center



automated electric press brake



electric press brake



horizontal bending machines



notching machines

EUROMAC®

Euromac Spa
Via per Sassuolo, 68/g
41043 Formigine (MO) - Italy
Tel. +39 059 579511
Fax +39 059 579512
info@euromac.it



PRODUCED & ASSEMBLED
IN ITALY BY EUROMAC

www.euromac.com

Disclaimer: Actual product may differ slightly from
images shown in this catalogue.
All information and data on this catalogue is
subject to change without notice.